

Metal Pipe Clamp with Rounded Ends

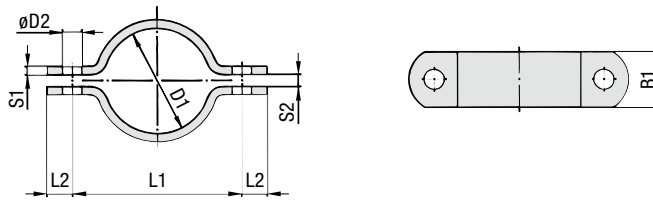

Order Codes

**Clamp Assembly** \*DIN 3567 A\*-20\*W1

One clamp assembly is consisting of two clamp halves.  
Hexagon head bolts and nuts are not included.

\* Clamp Assembly to DIN 3567, type A **DIN 3567 A**

\* STAUFF Group (Ø D1) **-20**

\* Material code Carbon Steel, untreated **W1**

STAUFF Group	Nominal Size		Dimensions (mm/in)						Accessories	
	Ø D1 (mm)	Pipe (in)	L1	L2	S1	S2	D2	B1		
20	15		57	15	5	7	11.5	30	M10 x 30 (M10) 3/8-16 UNC x 1-1/4 (3/8-16 UNC)	
			2.24	.59	.20	.28	.45	1.18		
22	15		59	15	5	7	11.5	30		
			2.32	.59	.20	.28	.45	1.18		
25	20		62	15	5	7	11.5	30		
			2.44	.59	.20	.28	.45	1.18		
27	3/4		66	15	5	7	11.5	30		
			2.60	.59	.20	.28	.45	1.18		
30	25		68	15	5	7	11.5	30		
			2.68	.59	.20	.28	.45	1.18		
34	1		72	15	5	7	11.5	30		
			2.83	.59	.20	.28	.45	1.18		
38	32		76	15	5	7	11.5	30		
			2.99	.59	.20	.28	.45	1.18		
43	1-1/4		82	15	5	7	11.5	30		
			3.23	.59	.20	.28	.45	1.18		
45	40		84	15	5	7	11.5	30		
			3.31	.59	.20	.28	.45	1.18		
49	1-1/2		88	15	5	7	11.5	30		
			3.46	.59	.20	.28	.45	1.18		
57	50		104	18	6	9	14	40	M12 x 35 (M12) 7/16-14 UNC x 1-3/8 (7/16-14 UNC)	
			4.09	.71	.24	.35	.55	1.57		
61	50	2	108	18	6	9	14	40		
			4.25	.71	.24	.35	.55	1.57		
77	65	2-1/2	122	18	6	9	14	40		
			4.80	.71	.24	.35	.55	1.57		
89	80	3	136	18	6	9	14	40		
			5.35	.71	.24	.35	.55	1.57		
108	100		172	24	8	11	18	50		
			6.77	.94	.31	.43	.71	1.97		
115	100	4	178	24	8	11	18	50		
			7.01	.94	.31	.43	.71	1.97		
133	125		196	24	8	11	18	50		
			7.72	.94	.31	.43	.71	1.97		
140	125		204	24	8	11	18	50		
			8.03	.94	.31	.43	.71	1.97		
159	150		222	24	8	11	18	50		M16 x 45 (M16) 5/8-11 UNC x 1-3/4 (5/8-11 UNC)
			8.74	.94	.31	.43	.71	1.97		
169	150		232	24	8	11	18	50		
			9.13	.94	.31	.43	.71	1.97		
194	175		258	24	8	11	18	50		
			10.16	.94	.31	.43	.71	1.97		
216	200		280	24	8	11	18	50		
			11.02	.94	.31	.43	.71	1.97		
220	200		284	24	8	11	18	50		
			11.18	.94	.31	.43	.71	1.97		
267	250		342	30	8	14	23	60		
			13.46	1.18	.31	.55	.91	2.36		
273	250		348	30	8	14	23	60		
			13.70	1.18	.31	.55	.91	2.36		
318	300		392	30	8	14	23	60	M20 x 50 (M20) 3/4-10 UNC x 2 (3/4-10 UNC)	
			15.43	1.18	.31	.55	.91	2.36		
324	300		398	30	8	14	23	60		
			15.67	1.18	.31	.55	.91	2.36		
368	350		444	30	8	14	23	60		
			17.48	1.18	.31	.55	.91	2.36		
407	400		498	36	10	18	27	70		
			19.61	1.42	.39	.71	1.06	2.76		
419	400		510	36	10	18	27	70		
			10.08	1.42	.39	.71	1.06	2.76		
521	500		614	36	10	18	27	70		
			24.17	1.42	.39	.71	1.06	2.76		