

Specifications

- 1¼", 1½" & 2" Forged Body Style
- Pressure Range: Up to 6000 PSI (400 bar)
- SAE Code 61 & 62 (SAE Standard J518)
- Split Flange Connectors
- Delrin +MoS2 Ball Seats
- Viton O-Rings
- Carbon Steel Construction
- Steel Handle
- Temperature Range: -20°F to 212°F (-28°C to 100°C)
- Zinc Plated Body

Options

- Split Flange Kits Available
SF Series for Both Code 61 & Code 62 (see page A39)
- Straight Handle
- Locking Kits
- Limit Switches
- Actuator Packages Available
- Stainless Steel
- Special Seat and "O"-Ring Materials
Available for Higher Temperatures or More Aggressive Media



Technical Information

Item Number	Quantity	Description
1	1	Body
2	1	Ball
3*	2	Seat
4*	2	Connector O-Ring
5*	2	Connector Back-Up Ring
6	2	Connector
7	1	Stop Pin
8	1	Stem
9*	1	Thrust Ring
10*	1	Stem O-Ring
11*	1	Stem Back-Up Ring
12	1	Cam Plate
13	1	Snap Ring
14	1	Handle
15	1	Washer
16	1	Stem Bolt

*Included in Seal Kit

Size	Part Number Without Flanges	Part Number With Flanges	Maximum Working Pressure	
			PSI	Bar
1¼"	CODE 61	FBV22200001M	3000 PSI	210
	CODE 62	FBV23200001M	6000 PSI	420
1½"	CODE 61	FBV22240001M	3000 PSI	210
	CODE 62	FBV23240001M	6000 PSI	420
2"	CODE 61	FBV22320001M	3000 PSI	210
	CODE 62	FBV23320001M	6000 PSI	420

Dimensional Information

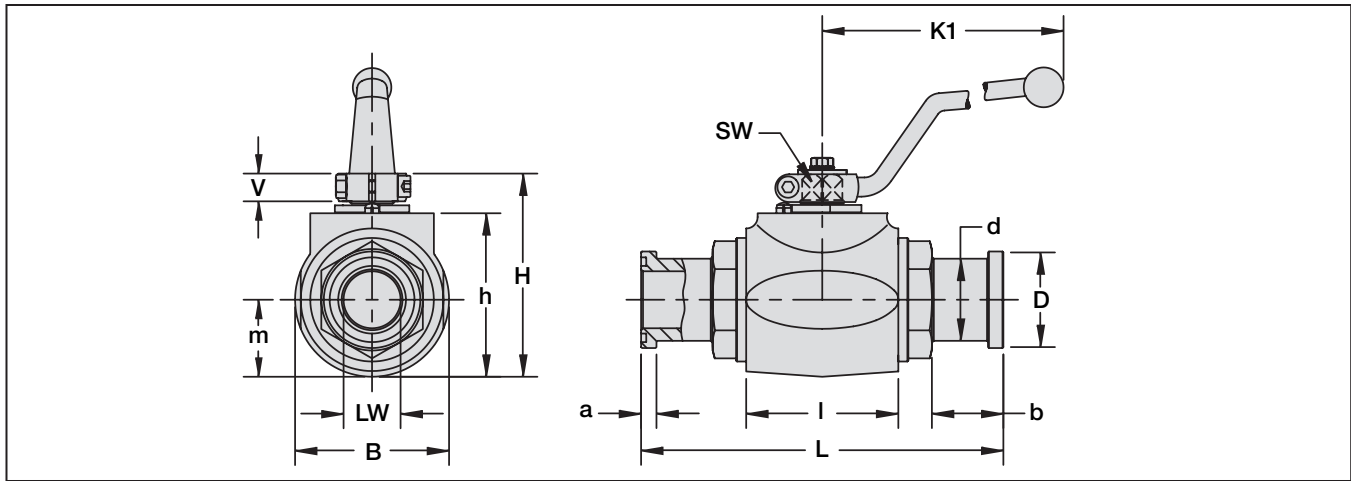

Code 61

Size	LW	L	I	B	H	h	m	V	SW	K1	D	d	a	b	Weight
	in / mm	in / mm	in / mm	in / mm	in / mm	in / mm	in / mm	in / mm	in / mm	in / mm	in / mm	in / mm	in / mm	in / mm	lbs / kg
1 1/4"	1.18 / 30.00	7.50 / 190.50	3.15 / 80.01	3.19 / 81.03	4.21 / 106.93	3.39 / 86.11	1.59 / 40.39	0.65 / 16.51	0.67 / 17	12.6 / 320	2.00 / 50.80	1.70 / 43.18	0.32 / 8.13	1.38 / 35.05	8 / 3.64
1 1/2"	1.42 / 38.00	9.09 / 230.89	3.35 / 85.09	3.94 / 100.08	4.88 / 123.95	4.06 / 103.12	1.97 / 50.04	0.65 / 16.51	0.67 / 17	12.6 / 320	2.37 / 60.20	1.98 / 50.29	0.32 / 8.13	2.09 / 53.09	14 / 6.36
2"	1.89 / 48.00	9.13 / 231.90	3.94 / 100.08	4.65 / 118.11	5.43 / 137.92	4.61 / 117.09	2.32 / 58.93	0.65 / 16.51	0.67 / 17	12.6 / 320	2.81 / 71.37	2.45 / 62.23	0.38 / 8.13	1.81 / 45.97	20 / 9.09

Code 62

Size	LW	L	I	B	H	h	m	V	SW	K1	D	d	a	b	Weight
	in / mm	in / mm	in / mm	in / mm	in / mm	in / mm	in / mm	in / mm	in / mm	in / mm	in / mm	in / mm	in / mm	in / mm	lbs / kg
1 1/4"	1.06 / 30.00	8.78 / 223.01	3.15 / 80.01	3.19 / 81.03	4.21 / 106.93	3.39 / 86.11	1.59 / 40.39	0.65 / 16.51	0.67 / 17	12.6 / 320	2.13 / 54.10	1.73 / 43.94	0.41 / 10.41	2.01 / 51.05	8.5 / 3.86
1 1/2"	1.26 / 38.00	11.06 / 280.92	3.35 / 85.09	3.94 / 100.08	4.88 / 123.95	4.06 / 103.12	1.97 / 50.04	0.65 / 16.51	0.67 / 17	12.6 / 320	2.50 / 63.50	2.01 / 51.05	0.50 / 12.70	3.07 / 77.98	15 / 6.82
2"	1.77 / 48.00	12.44 / 315.98	3.94 / 100.08	4.65 / 118.11	5.43 / 137.92	4.61 / 117.09	2.32 / 58.93	0.65 / 16.51	0.67 / 17	12.6 / 320	3.13 / 79.50	2.65 / 67.31	0.50 / 12.70	3.46 / 87.88	21 / 9.55

Ordering Information

