

Specifications

- Forged Body, High Pressure Valves
- 1/4" – 2" Fully Ported
- NPT, BSP or SAE O-Ring Connections
- Delrin +MoS2 Ball Seats
- Viton O-Rings
- Steel Handle
- Pressure Range: Up to 5000 PSI (345 bar)
- Carbon Steel Construction
- Temperature Range: -20°F to 212°F (-28°C to 100°C)
- Zinc Plated Body



Options

- Locking Kits
- Limit Switches
- Stainless Steel Body
- Stainless Steel Ball and Stem
- Straight Handles
- Actuator Packages Available
- Special seat and "O"-Ring materials available for higher temperatures or more aggressive media.

Technical Information

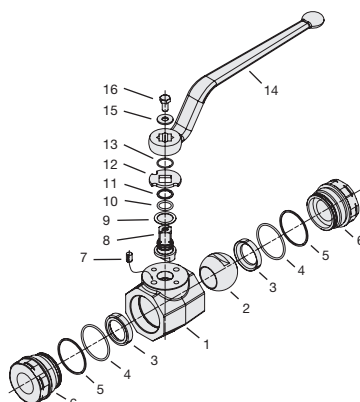

Item Number	Quantity	Description
1	1	Body
2	1	Ball
3*	2	Seat
4*	2	Connector O-Ring
5*	2	Connector Back-Up Ring
6	2	Connector
7	1	Stop Pin
8	1	Stem
9*	1	Thrust Ring
10*	1	Stem O-Ring
11*	1	Stem Back-Up Ring
12	1	Cam Plate
13	1	Snap Ring
14	1	Handle
15	1	Washer
16	1	Stem Bolt

*Included in Seal Kit

Size	Part Number	Maximum Working Pressure	
		PSI	Bar
1/4"	NPT	6000 PSI	420
	SAE	6000 PSI	420
1/2"	NPT	6000 PSI	420
	SAE	6000 PSI	420
2"	NPT	6000 PSI	420
	SAE	6000 PSI	420

Dimensional Information

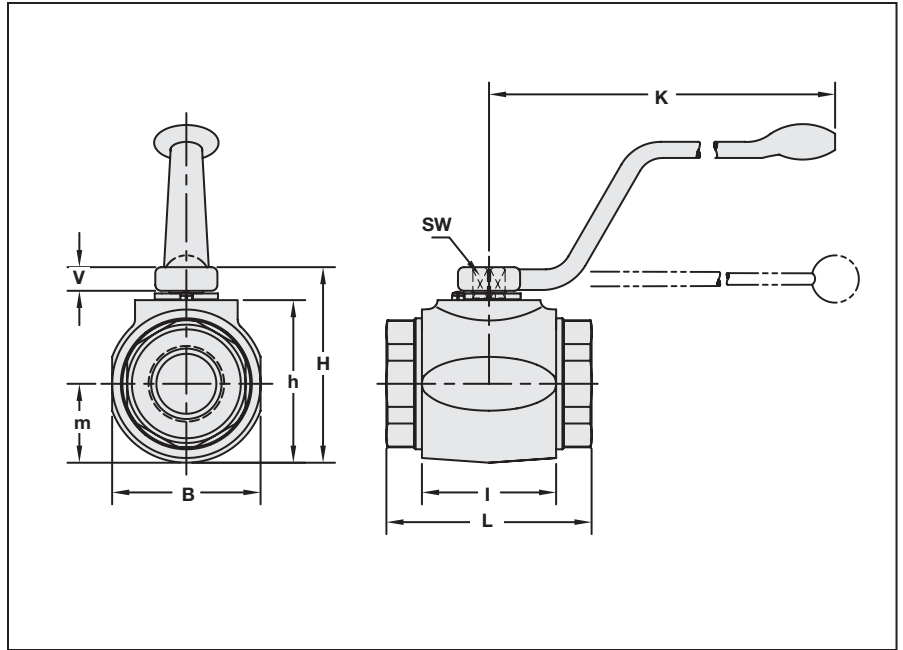
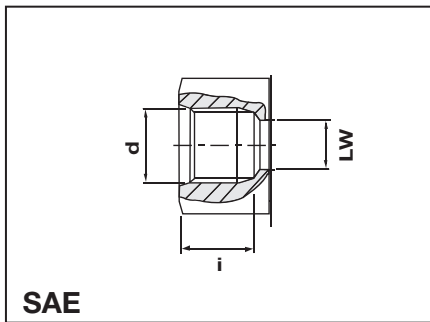
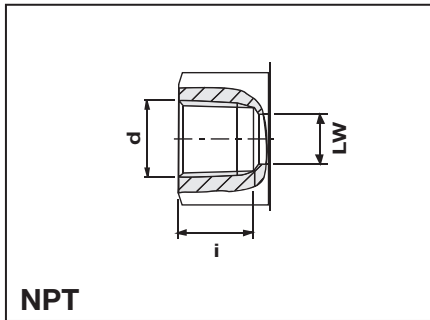

Size	d NPT	d SAE	i NPT	i SAE	L NPT	L SAE	LW NPT	LW SAE	I	B	H	h	m	V	SW	K	Weight
			in mm	in mm	in mm	in mm	in mm	in mm	in mm	in mm	in mm	in mm	in mm	in mm	in mm	in mm	lbs kg
1¼"	1¼-1½	1¼-12	1.11 28.19	0.91 23.11	4.72 119.89	4.37 111.00	1.26 32.00	1.18 29.97	3.15 80.01	3.19 81.03	4.21 106.93	3.39 86.11	1.59 40.39	0.65 16.51	.66 17	11.81 320	8.04 3.65
1½"	1½-1½	1¼-12	1.1 27.94	0.91 23.11	5.12 130.05	5.12 130.05	1.50 38.10	1.50 38.10	3.35 85.09	3.94 100.08	4.88 123.95	4.06 103.12	1.97 50.04	0.65 16.51	.66 17	11.81 320	13.00 5.91
2"	2-1½	2¼-12	1.19 30.23	0.91 23.11	5.51 139.95	5.51 139.95	1.89 48.01	1.77 44.96	3.94 100.08	4.65 118.11	5.43 137.92	4.61 117.09	2.32 58.93	0.65 16.51	.66 17	11.81 320	19.00 8.64

Ordering Information

