

## Specifications

- Compact Direct Mount Sandwich Style Shut Off Valve
- 1/2"-2" Code 61 or Code 62
- Pressure Range up to 6000 psi (420 bar)
- Temperature Range -30°F to 212°F (-34°C to 100°C)
- Carbon Steel Construction
- Zinc Plated Body

## Options

- Actuator Packages Available
- Limit Switches
- Safety Lock out
- Flanges Available
- Stainless Steel construction

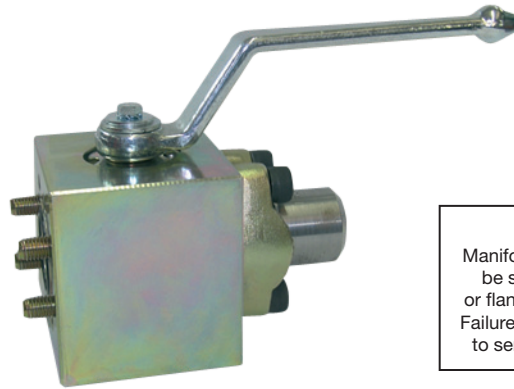

**Note:**  
Manifold Side of valve must be secured to manifold or flange prior to operation. Failure to comply could lead to serious injury or death.

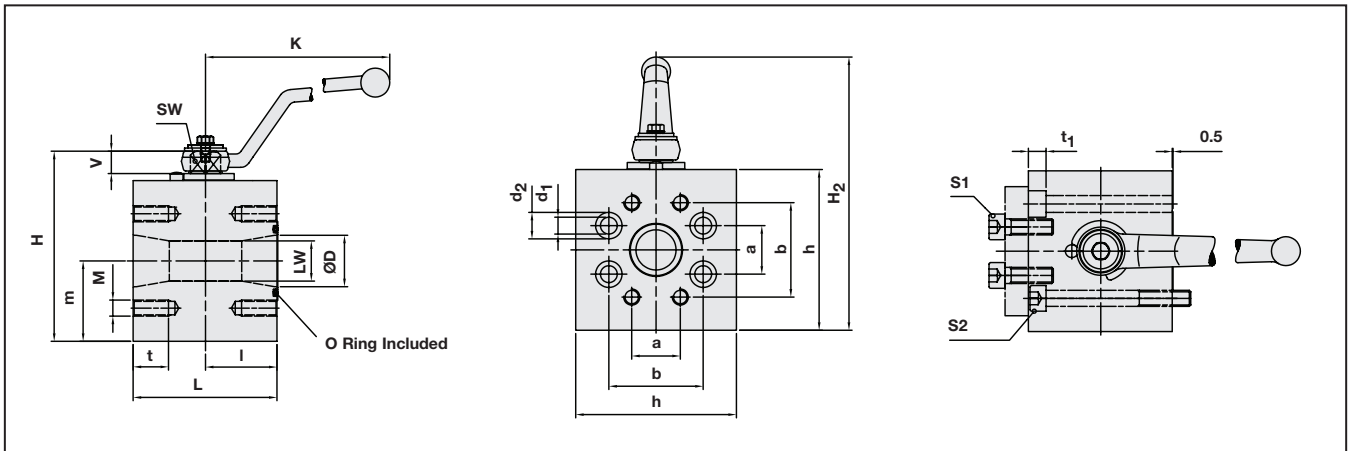

## ISO 6162-1 3000 psi/21 MPa

Part Number	SIZE	DN	LW	D	L	I	H	h	m	c	K	SW	V	a	b	M	t	d <sub>1</sub>	d <sub>2</sub>	t <sub>1</sub>	H <sub>2</sub>
KHZ27080001M	mm	13	13	13	68	34	65	60	30	21	115	9	11	17,5	38,1	5/16"UNC	15	8,5	13,5	9	102
	in	0.51	0.51	0.51	2.68	1.34	2.56	2.36	1.18	0.83	4.53	0.35	0.43	0.69	1.50	5/16"UNC	0.59	0.33	0.53	0.35	4.02
KHZ27120001M	mm	20	20	20	70	35	88	75	37,5	32,5	170	14	14	22,3	47,6	3/8"UNC	17	10,5	16,5	11	141
	in	0.79	0.79	0.79	2.76	1.38	3.46	2.95	1.48	1.28	6.69	0.55	0.55	0.88	1.87	3/8"UNC	0.67	0.41	0.65	0.43	5.55
KHZ27160001M	mm	25	25	25	78	39	98	85	44	35,5	170	14	14	26,2	52,4	3/8"UNC	17	10,5	16,5	11	150
	in	0.98	0.98	0.98	3.07	1.54	3.86	3.35	1.73	1.40	6.69	0.55	0.55	1.03	2.06	3/8"UNC	0.67	0.41	0.65	0.43	5.91
KHZ27200001M	mm	32	25	32	90	45	104	100	50	35,5	170	14	14	30,2	58,7	7/16"UNC	21	10,5	16,5	11	156
	in	1.26	0.98	1.26	3.54	1.77	4.09	3.94	1.97	1.40	6.69	0.55	0.55	1.19	2.31	7/16"UNC	0.83	0.41	0.65	0.43	6.14
KHZ27240001M	mm	40	32	38	99	49,5	127	120	60	45,5	306	17	17	35,7	69,9	1/2"UNC	21	13	19	13	191
	in	1.57	1.26	1.50	3.90	1.95	5.00	4.72	2.36	1.75	12.04	0.67	0.67	1.41	2.75	1/2"UNC	0.83	0.51	0.75	0.51	7.52
IKHZ27320001M	mm	50	38	49	120	60	144	140	70	53	306	17	17	42,9	77,8	1/2"UNC	21	13	19	13	208
	in	1.97	1.50	1.93	4.72	2.36	5.67	5.51	2.76	2.09	12.04	0.67	0.67	1.69	3.06	1/2"UNC	0.83	0.51	0.75	0.51	8.19

## ISO 6162-2 6000 psi/42 MPa

Part Number	SIZE	DN	LW	D	L	I	H	h	m	c	K	SW	V	a	b	M	t	d <sub>1</sub>	d <sub>2</sub>	t <sub>1</sub>	H <sub>2</sub>
KHZ28080001M	mm	13	13	13	68	34	65	60	30	21	115	9	11	18,2	40,5	5/16"UNC	15	8,5	13,5	9	102
	in	0.51	0.51	0.51	2.68	1.34	2.56	2.36	1.18	0.83	4.53	0.35	0.43	.072	1.59	5/16"UNC	0.59	0.33	0.53	0.35	4.02
KHZ28120001M	mm	20	20	20	70	35	88	75	37,5	32,5	170	14	14	23,8	50,8	3/8"UNC	17	10,5	16,5	11	141
	in	0.79	0.79	0.79	2.76	1.38	3.46	2.95	1.48	1.28	6.69	0.55	0.55	0.94	2.00	3/8"UNC	0.67	0.41	0.65	0.43	5.55
KHZ28160001M	mm	25	25	25	78	39	98	85	44	35,5	170	14	14	27,8	57,2	7/16"UNC	21	13	19	13	150
	in	0.98	0.98	0.98	3.07	1.54	3.86	3.35	1.73	1.40	6.69	0.55	0.55	1.09	2.25	7/16"UNC	0.83	0.51	0.75	0.51	5.91
KHZ28200001M	mm	32	25	32	90	45	104	100	50	35,5	170	14	14	31,8	66,6	1/2"UNC	20	13	19	13	156
	in	1.26	0.98	1.26	3.54	1.77	4.09	3.94	1.97	1.40	6.69	0.55	0.55	1.25	2.62	1/2"UNC	0.79	0.51	0.75	0.51	6.14
KHZ28240001M	mm	40	32	38	99	49,5	127	120	60	45,5	306	17	17	36,5	79,3	5/8"UNC	26	17	25	17,5	191
	in	1.57	1.26	1.50	3.90	1.95	5.00	4.72	2.36	1.75	12.04	0.67	0.67	1.44	3.12	5/8"UNC	1.02	0.67	0.98	0.69	7.52
IKHZ28320001M	mm	50	38	49	120	60	144	140	70	53	306	17	17	44,5	96,8	3/4"UNC	34	21	31	21,5	208
	in	1.97	1.50	1.93	4.72	2.36	5.67	5.51	2.76	2.09	12.04	0.67	0.67	1.75	3.81	3/4"UNC	1.34	0.83	1.22	0.85	8.19