

Valves

The optional valves are fitted as an insert in the filter head and incorporate the spigot on which the element seals. The valve is selected to suit the filter application.

HV-O **Non-bypass standard insert** without any valve function. Element collapse rating should be higher than system pressure

HV-B **By-pass valve** which allows oil to bypass the element when the differential pressure across the element reaches $6^{+0,5}$ bar ($87^{+7,25}$ PSI). (Other pressure settings available on request). The opening pressure should be higher than the Δp setting of an optional clogging indicator. Low collapse (30 bar / 435 PSI Δp) elements are normally used with this valve.

HV-R **Reverse flow valve** is used in systems where there is flow in reverse through the filter. It allows reverse flow without back-flushing the element but does not filter in the reverse direction. Element collapse rating should be higher than the system pressure.

HV-N **Non-return valve**
This valve prevents the oil in the delivery line from draining out while the filter is being serviced. Because there is no by-pass, the element collapse rating should be higher than system pressure.

HV-M **Multi-function valve**
This valve combines the by-pass, the reverse flow and the non-return functions in one unit. The by-pass opening pressure is $6^{+0,5}$ bar ($87^{+7,25}$ PSI) Δp with other opening pressures available on request. The opening pressure should be higher than the Δp setting of an optional clogging indicator. Low collapse (30 bar / 435 PSI Δp) elements are normally used with this valve.

HV - M 014/030 /X

Valves

Design Code
only for information

Code	Valve Type
O	Non-bypass standard insert without any valve
B	By-pass Valve
R	Reverse Flow Valve
N	Non Return Valve
M	Multi-Function Valve

Filter Group
014/030
045/070/125
090/160/250/300

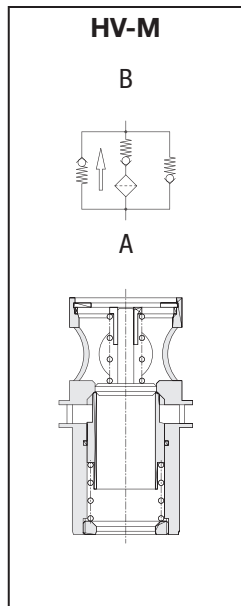
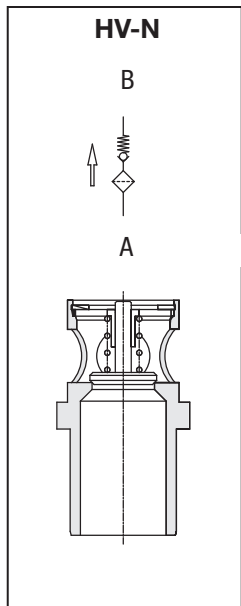
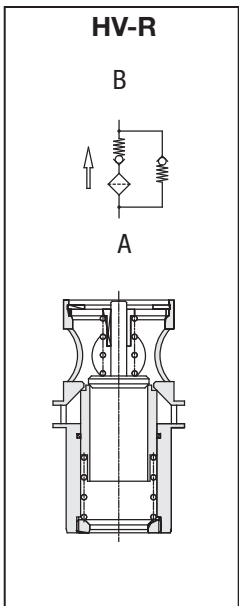
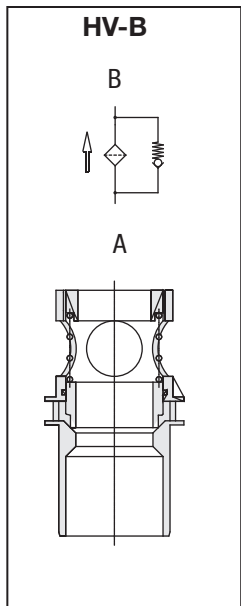
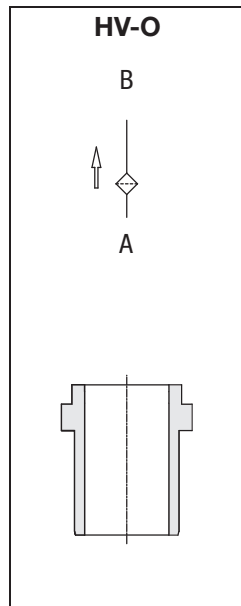

Flow characteristics of the valves see page F11