

## Design of Clamp Bodies

### STANDARD-SERIES

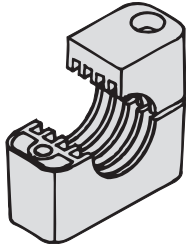

Standard design  
– profiled inside –

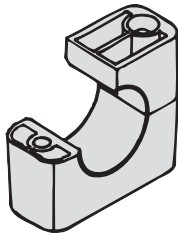

H-design  
– smooth inside –  
(recommended for hoses)

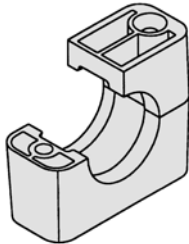

RI-design  
for rubber inserts

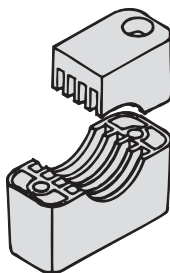

Oval-design  
(for electric cables)

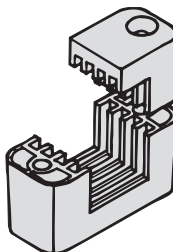

Rectangular-design  
(for square sensors)

### HEAVY-SERIES

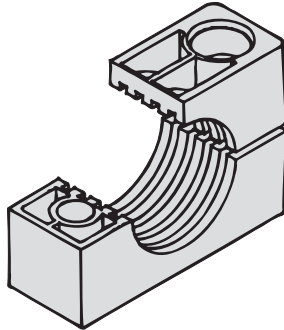

Standard design  
– profiled inside –

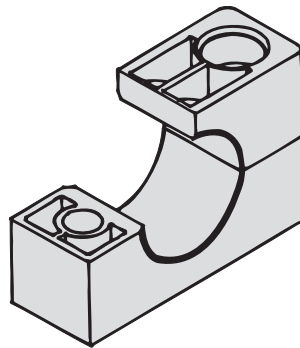

H-design  
– smooth inside –  
(recommended for hoses)

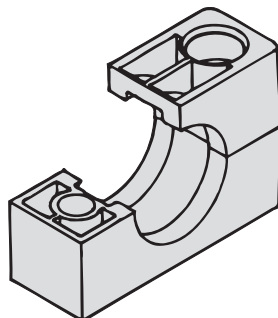

### TWIN-SERIES

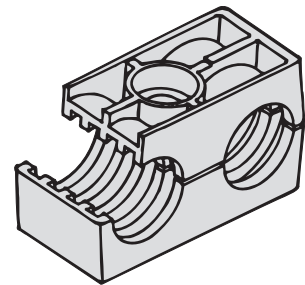

Standard design  
– profiled inside –

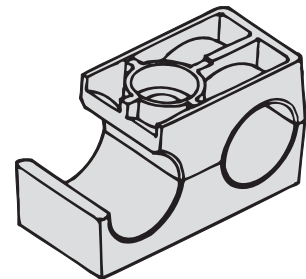

H-design  
– smooth inside –  
(recommended for hoses)