

Specifications

- Electroless Nickel Plated Steel Construction
- Maximum Operating Temperature 500°F (260°C)
- Hermetically Sealed Glass Prism Lenses
- Easy Installation

Options

- SAE Thread (contact factory)
- Stainless Steel (contact factory)



Dimensions

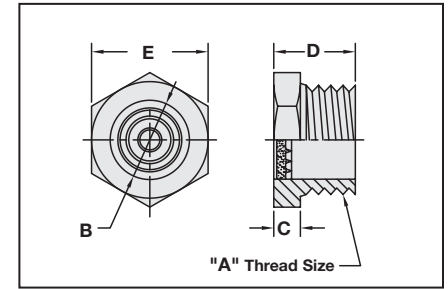

Part Number	Thread Size A	Diameter B		C		D		E Hex.		Maximum Operating Pressure	
		mm	in	mm	in	mm	in	mm	in	PSI	bar
SLW-04	1/4"-18 NPT	8.6	0.34	4.8	0.19	16.0	0.63	16.0	0.63	4000	275
SLW-06	3/8"-18 NPT	11.2	0.44	5.6	0.22	18.3	0.72	19.1	0.75	3700	250
SLW-08	1/2"-14 NPT	14.2	0.56	5.6	0.22	19.8	0.78	23.9	0.94	3500	240
SLW-12	3/4"-14 NPT	19.1	0.75	8.1	0.32	23.9	0.94	26.9	1.06	3000	200
SLW-16	1"-11 1/2 NPT	23.9	0.94	8.1	0.32	31.8	1.25	35.1	1.38	2500	170
SLW-20	1 1/4"-11 1/2 NPT	30.5	1.20	10.4	0.41	31.0	1.22	44.5	1.75	2000	138
SLW-24	1 1/2"-11 1/2 NPT	36.6	1.44	10.4	0.41	31.0	1.22	50.8	2.00	1500	100
SLW-32	2"-11 1/2 NPT	47.8	1.88	10.4	0.41	32.5	1.28	63.5	2.50	1000	70

Plastic Sight Glasses OLG Series

Specifications

- Polyamid Construction (TR-90-UV)
- Operating Temperature -22°F (-30°C) to 194°F (90°C)
- Maximum Operating Pressure 75 PSI (5 bar)
- SAE Thread
- Easy Installation



Dimensions

Part Number	Thread	SW		D1		D2		L1		L2	
		mm	in	mm	in	mm	in	mm	in	mm	in
OLG-U08-P-P	3/4"-16 UNF	22	0.9	22	0.9	14	0.55	8	0.31	11	0.43
OLG-U12-P-P	1 1/16"-12 UNF	32	1.26	32	1.26	20	0.79	11.9	0.47	15.1	0.54
OLG-U16-P-P	1 5/16"-12 UNF	41	1.61	41	1.61	25	1.00	12.9	0.51	15.1	0.54
OLG-U20-P-P	1 5/8"-12 UNF	50	1.97	50	1.97	30	1.18	15.9	1.63	15.1	0.54

