

## Specifications

- Black Epoxy Coated Metal Shroud with Polyamid Sight Tube
- Suitable for Use with Mineral and Petroleum Based Hydraulic Fluids and Lubricants.
- Maximum Operating Temperature 194°F (90°C)
- Thermometer Calibration from -14°F (-10°C) to 176°F (80°C)
- SNA 076 has M10 Bolts as Standard
- SNA 127, SNA 254, SNA305 have M12 Bolts as Standard
- **Tightening Torque 70 in/lb (7.9 Nm)**

## Options

- Viton Seals
- Dial Thermometer Available with 7.9 in (200mm) or 11.8 in (300mm) Probe
- Other Special Seals Available upon Request
- Special Customized Scale Plates Available
- 1/2" UNC Bolts Available on SNA 127, 254 or 305
- M12 Bolts Available on SNA 076
- Special Lengths Available on Request
- Special plastic sight tubes available for improved UV resistance or special fluids

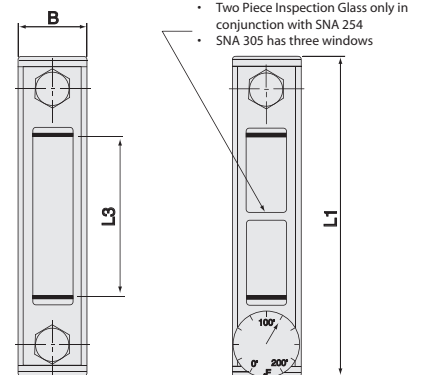
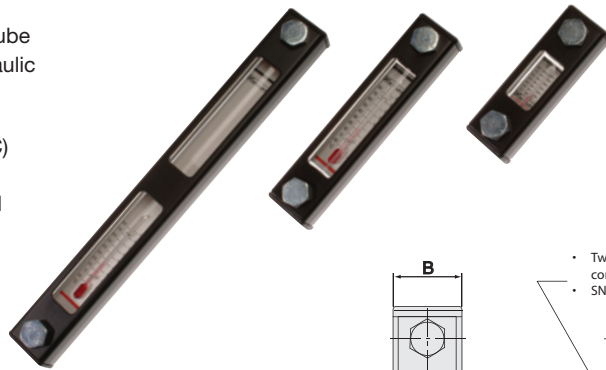

Please consult factory on the use of special fluids such as biological fluids, diesel oils, gasoline, etc.

## Dimensions

	SNA 076		SNA 127		SNA 254		SNA 305	
	mm	in	mm	in	mm	in	mm	in
<b>A</b>	45	1.77	45	1.77	45	1.77	45	1.77
<b>B</b>	34.5	1.34	34.5	1.34	34.5	1.34	34.5	1.34
<b>C</b>	8 MAX	0.32 MAX	8 MAX	0.32 MAX	8 MAX	0.32 MAX	8	0.32
<b>D</b>	27	1.06	27	1.06	27	1.06	27	1.06
<b>E</b>	M10		M12		M12		M12	
<b>L1</b>	108	4.25	159	6.25	286	11.25	336	13.2
<b>L2</b>	76	3.00	127	5.00	254	10.00	305	12.0
<b>L3</b>	39	1.45	76	3.00	203	8.00	255	10.0
<b>T1</b>	200	7.88	200	7.88	200	7.88	200	7.88
<b>T2</b>	302	11.88	302	11.88	302	11.88	302	11.88

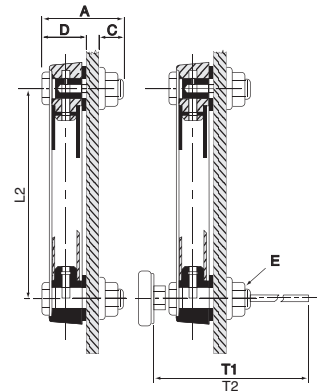

## Ordering Information

SNA		127	B	S	T1	12	O60	Thermo Switch (see page A28 for details)		
<b>Type</b>		SNA								
<b>Series</b>										
076	SNA 076 (3")									
127	SNA 127 (5")									
254	SNA 254 (10")									
305	SNA 305 (12")									
<b>Seal Material</b>										
B	BUNA NBR (Standard)									
V	VITON FPM									
<b>Design of Scale Plate</b>										
S	With Stauff-Logo (Standard)									
N	No Logo									
X	Custom Design									
									<b>Banjo Bolts</b>	
									12	M 12 (Standard SNA 127, 254 & 305)
									10	M 10 (Standard SNA 076)
									U	1/2" UNC (Available for 127, 254 & 305)
									<b>Thermometer</b> (Dial thermometer with probe T1/T2 for size M12 and for 1/2" UNC / UNF)	
									O	Without Thermometer
									T	Capillary Tube Thermometer on Scale Plate
									T1	Dial Thermometer With 200 mm (7.9") Probe
									T2	Dial Thermometer With 300 mm (11.8") Probe
									TB	Blue Capillary Tube Option

## Specifications

- Black Epoxy Coated Metal Shroud with Polyamid Sight Tube
- Suitable for Use with Mineral and Petroleum Based Hydraulic Fluids, Lubricants and Gasoline.
- Maximum Operating Temperature 194°F (90°C)
- Thermometer Calibration from 14°F (-10°C) to 176°F (80°C)
- Electrical Contact Made at Minimum Oil Level.
- Viton Seals, M12 Bolts
- Tightening Torque 70 in-lbs
- Standard Plug Type "C" or "O" per DIN ISO 6952

## Options

- Dial Thermometer Available with 200mm (7.9") or 300mm (11.8") Probe
- 1/2" UNC Bolts Available
- Special Improved UV Resistant Plastic Sight Tube
- Special Lengths Available upon Request
- PT100 Sensor for Constant Temperature Feedback
- PT100-D Display Unit for Display and Analysis of PT100 Signals



## Electrical Connections and Functions

Contact load:  
max 10 W (Type C)  
max 3 W (Type O)

Bias-reducing Potential:  
50 V AC/DC

Current on Contact  
max 0,50 A (Type C)  
max 0,25 A (Type O)

Electrical switch PG 9  
Protection IP65  
Connection 3 is not engaged

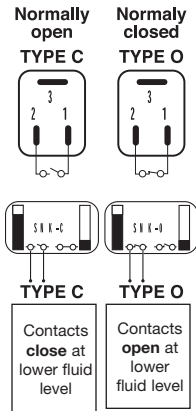

## Dimensions

	SNK 127		SNK 254		SNK 305	
	mm	in	mm	in	mm	in
<b>A</b>	56	<b>2.20</b>	56	<b>2.20</b>	56	<b>2.20</b>
<b>B</b>	34.5	<b>1.36</b>	34.5	<b>1.36</b>	34.5	<b>1.36</b>
<b>C</b>	8.2 MAX	<b>0.32 MAX</b>	8.2 MAX	<b>0.32 MAX</b>	8 MAX	<b>0.32 MAX</b>
<b>D</b>	35.1	<b>1.38</b>	35.1	<b>1.38</b>	35.1	<b>1.38</b>
<b>E</b>	49.8	<b>1.96</b>	49.8	<b>1.96</b>	50	<b>1.96</b>
<b>L1</b>	203.2	<b>8.00</b>	330	<b>13.00</b>	363	<b>14.3</b>
<b>L2</b>	127	<b>5.00</b>	254	<b>10.00</b>	305	<b>12.0</b>
<b>T1</b>	200	<b>7.88</b>	200	<b>7.88</b>	200	<b>7.88</b>
<b>T2</b>	302	<b>11.88</b>	302	<b>11.88</b>	302	<b>11.88</b>

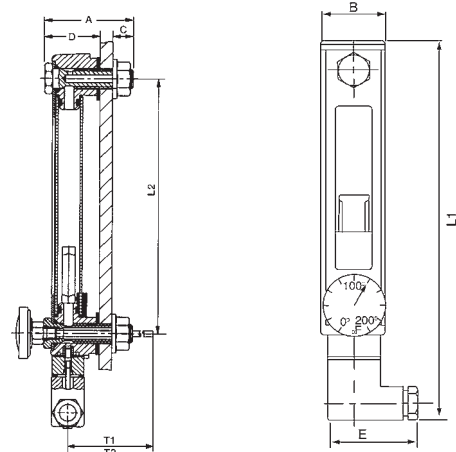

## Ordering Information

**SNK 127 V C T1 12 O60**

Type	SNK
SNKK	

Series	127 SNK / SNKK 127 (5")
254 SNK / SNKK 254 (10")	
305 SNK / SNKK 305 (12")	

Seal Material	V Viton FPM (Standard)
---------------	------------------------

Switch Function	C Make Contact, Closes at Minimum Level (n/o)
O Break Contact, Opens at Minimum Level (n/c)	
DD SPDT Contacts, Switches at Minimum Level*	

Thermo Switch / Sensor (see page A31 for details)	
(none)	Without Thermo Switch / Sensor
O60	TS-SNA / SNK-O-60
O70	TS-SNA / SNK-O-70
O80	TS-SNA / SNK-O-80
PT	TS-SNA / SNK-PT100

Banjo Bolts	
12	M 12 (Standard with Thermo Option)
10	M 10
U	1/2" UNC

Thermometer (for size M12 only)	
O	Without Thermometer
T1	Dial Thermometer With 200mm Probe (7.9")
T2	Dial Thermometer With 300mm Probe (11.8")

\* SNKK style only



## Characteristics / Materials:

Visual / electrical fluid level indication in hydraulic reservoirs

- Ideal for all areas of application in which space is limited: compact design and space-saving installation
- 40mm shorter in comparison with level gauge SNK with plug according to industry standard DIN EN 175301-803-B/ISO6952
- Protection class IP67 (IP69K on request) enables the use of the SNKK even under rough conditions (e.g. for construction, forestry and agricultural machinery) and also cleaning with a high-pressure washer
- Equipped with plug M12 according to IEC-61076-2-101 and with a changeover switch as delivery standard
- Also available with dial thermometer with probe, with thermo switch or with temperature sensor and a display unit

## Temperature Sensor TS-SNA/SNK-PT100

Indication of oil temperature in conjunction with level gauges SNA, SNK and SNKK

- Replaces the lower banjo bolt of the level gauge
- Measuring range: -40°C ... +150°C (-40°F ... 302°F)
- Connection: M12 connector
- Analysis of signals with system-sided measuring amplifier or with display unit TS-SNA/SNK-PT100-D

## Display Unit TS-SNA/SNK-PT100-D

Sensing, displaying and evaluation of temperatures; generation of corresponding output signals

- Precise accessory for service staff to easily and quickly locate problems on the spot
- Measuring range: -40°C ... +300°C (-40°F ... 572°F)
- Operating voltage: 20...30V
- Two output signals with options to choose:
  - signal 1: normally open / closed (programmable, incl. hysteresis func.)
  - signal 2: analog (4...20 mA / 0...10VDC, scalable)



## Area of Application:

Oil temperature indicator is to be used in conjunction with STAUFF level gauges SNA, SNK and SNKK.

## Characteristics / Materials:

- Available with 60°C (140°F), 70°C (158°F) or 80°C (176°F) switching temperature
- Activation takes place when the respective switching temperature is exceeded.
- Electrical function: Type O break contact, normally closed
- Steel parts made out of Steel (1.0718)
- Plastic parts made out of glass fiber reinforced polyamide

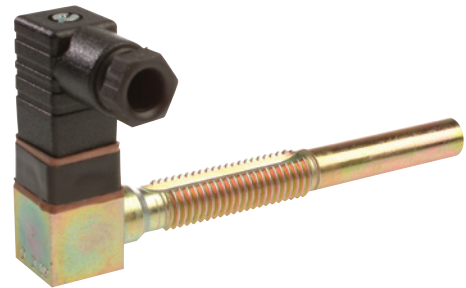

Thermo switches are available for the standard mounting size M12 only.

## Dimensions Dimensions in mm (inch)

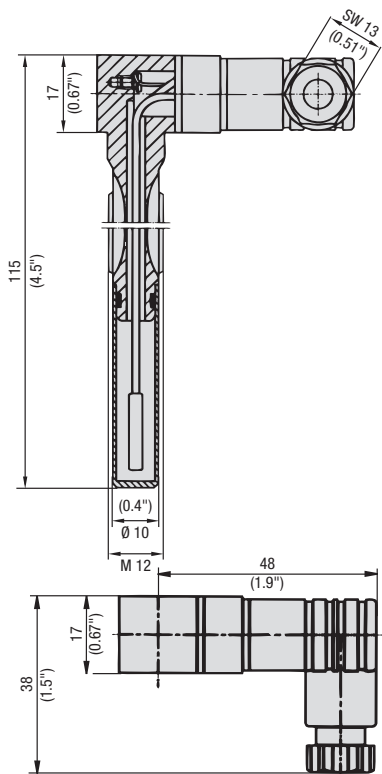

## Technical Data (Break contact):

Switching temperature: see ordering code  
 Hysteresis: 20° C (68°F)  
 Switching temperature tolerance: 6.5°C (44°F)

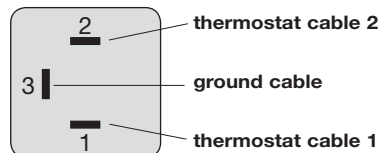

### Alternating current

- max voltage 250 VAC
- max current at 10.000 cycles  
 ≈ 2,5 A at cosØ = 1,0  
 ≈ 1,6 A at cosØ = 0,6
- max current at 100.000 cycles  
 ≈ 0,5 A at cosØ = 1,0  
 ≈ 0,25 A at cosØ = 0,6
- min current 50 mA

### Direct current

- max voltage 42 VDC
- max current at 10.000 cycles 1 A

## Example of application

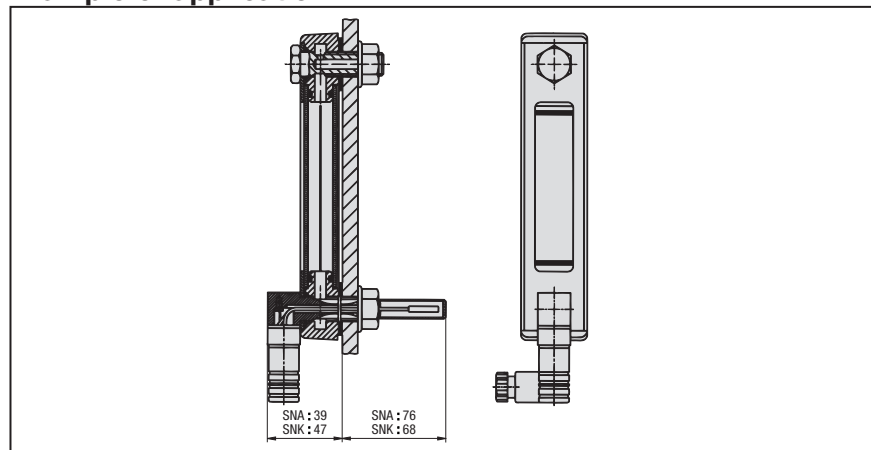

## Ordering Code and Temperature Range

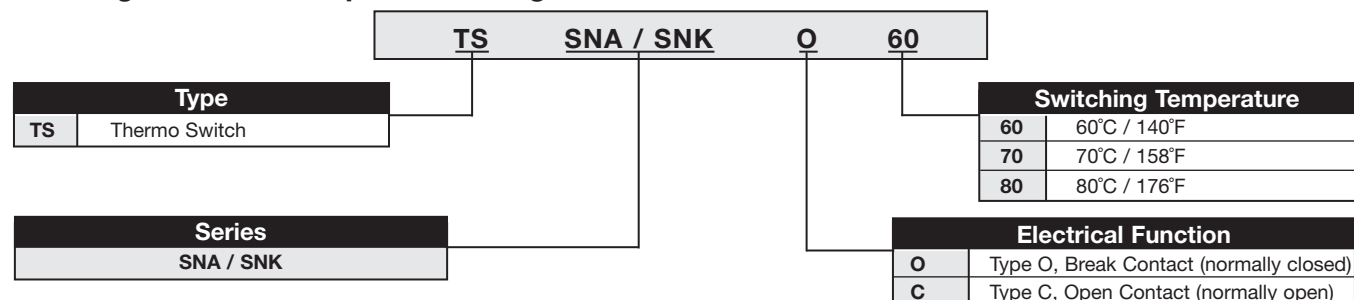

Thermo switches can be ordered both as a single component and in combination with STAUFF level gauges SNA and SNK. See pages A26 and A27.

## Specifications

- Electroless Nickel Plated Steel Construction
- Maximum Operating Temperature 500°F (260°C)
- Hermetically Sealed Glass Prism Lenses
- Easy Installation

## Options

- SAE Thread (contact factory)
- Stainless Steel (contact factory)

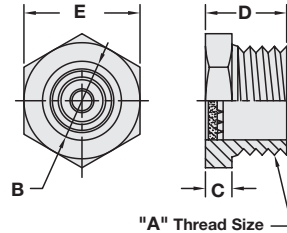

## Dimensions

Part Number	Thread Size A	Diameter B		C		D		E Hex.		Maximum Operating Pressure	
		mm	in	mm	in	mm	in	mm	in	PSI	bar
SLW-04	1/4"-18 NPT	8.6	0.34	4.8	0.19	16.0	0.63	16.0	0.63	4000	275
SLW-06	3/8"-18 NPT	11.2	0.44	5.6	0.22	18.3	0.72	19.1	0.75	3700	250
SLW-08	1/2"-14 NPT	14.2	0.56	5.6	0.22	19.8	0.78	23.9	0.94	3500	240
SLW-12	3/4"-14 NPT	19.1	0.75	8.1	0.32	23.9	0.94	26.9	1.06	3000	200
SLW-16	1"-11 1/2 NPT	23.9	0.94	8.1	0.32	31.8	1.25	35.1	1.38	2500	170
SLW-20	1 1/4"-11 1/2 NPT	30.5	1.20	10.4	0.41	31.0	1.22	44.5	1.75	2000	138
SLW-24	1 1/2"-11 1/2 NPT	36.6	1.44	10.4	0.41	31.0	1.22	50.8	2.00	1500	100
SLW-32	2"-11 1/2 NPT	47.8	1.88	10.4	0.41	32.5	1.28	63.5	2.50	1000	70

# Plastic Sight Glasses OLG Series

## Specifications

- Polyamid Construction (TR-90-UV)
- Operating Temperature -22°F (-30°C) to 194°F (90°C)
- Maximum Operating Pressure 75 PSI (5 bar)
- SAE Thread
- Easy Installation



ACCESSORIES

## Dimensions

Part Number	Thread	SW		D1		D2		L1		L2	
		mm	in	mm	in	mm	in	mm	in	mm	in
OLG-U08-P-P	3/4"-16 UNF	22	0.9	22	0.9	14	0.55	8	0.31	11	0.43
OLG-U12-P-P	1 1/16"-12 UNF	32	1.26	32	1.26	20	0.79	11.9	0.47	15.1	0.54
OLG-U16-P-P	1 5/16"-12 UNF	41	1.61	41	1.61	25	1.00	12.9	0.51	15.1	0.54
OLG-U20-P-P	1 5/8"-12 UNF	50	1.97	50	1.97	30	1.18	15.9	1.63	15.1	0.54

